

1. MOUNTING THE SSS-5 ON THE DOOR

1/ Do not mount the sensor higher than 2.6 [m] (8' 6").

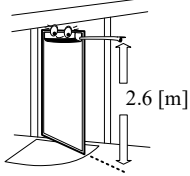

2/ Use a weather cover if the unit is installed where rain will fall directly on it.

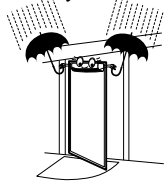

3/ Unscrew the Side Covers and remove the Filter Cover.

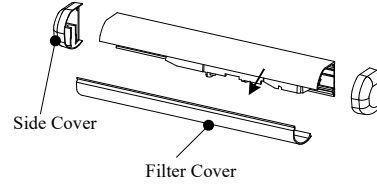

4/ Remove the Angle Stabilizer and loosen the screw on one of the PCB Holders to slide it aside and remove the PCB Unit.

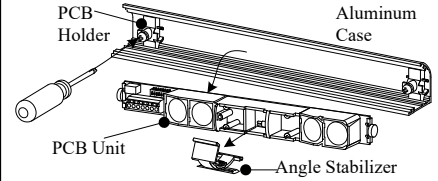

5/ Attach the Aluminium Case to the door with the screws provided. The Aluminum Case(s) should be located close to the Leading edge of the door to maximise safety detection.

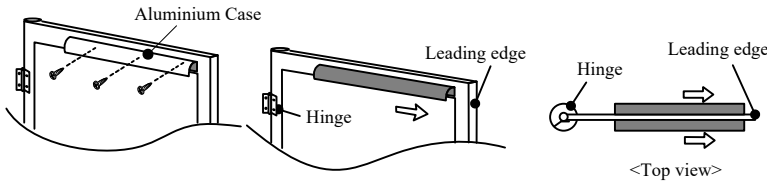

6/ Reinsert the PCB unit, making sure that the side marked "LEADING EDGE" is closest to the leading edge of the door. Re-attach the Angle Stabilizer and tighten the screws on the PCB Holders.

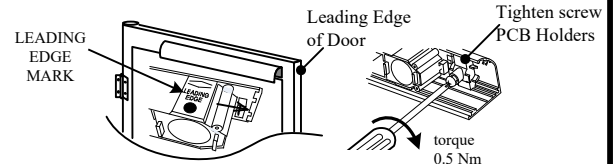

2. WIRING TO THE DOOR CONTROLLER

1/ Drill Holes as indicated and install the Jamb Hole Cover A on the door controller

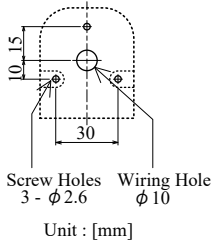

2/ Clamp the Wire Sheath between the Jamb Hole Cover A/B

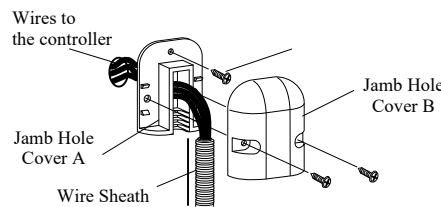

3/ Remove the Terminal Block from the PCB unit and connect the wires from the door controller to it as indicated. See wiring options below.

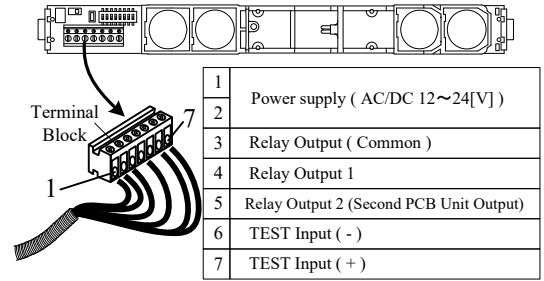

4/ **Option 1:** Plan view, wiring PCB units on both side of the door independently back to the door controller

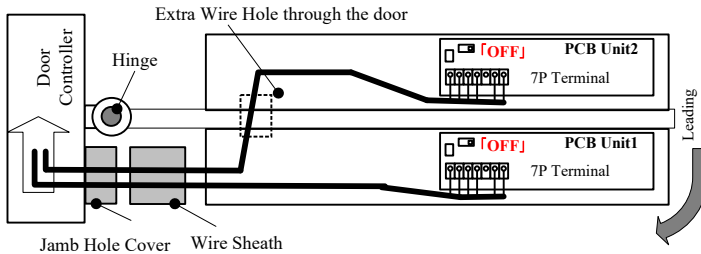

4/ **Option 2:** PCB units on both sides of the door connected via communication cable and only 1 PCB unit wired back to door controller

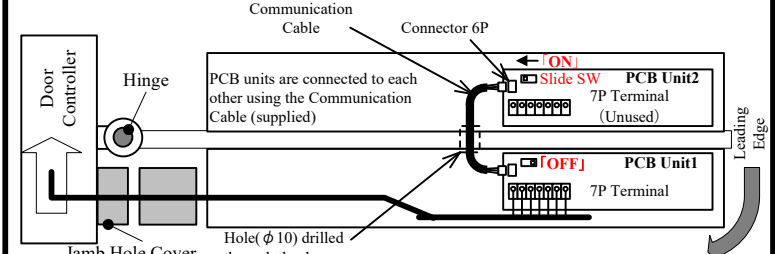

Note: Remember to set the Slide SW as indicated

Note: Remember to set the Slide SW as indicated

3. DIPSWITCH SETTINGS

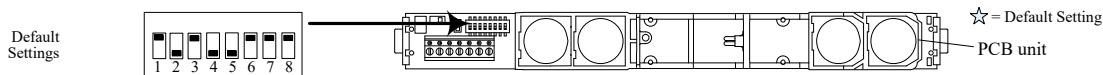

1/ Test Input

When connected to a door controller with a TEST input, set to "B".
When connected to a door controller without a TEST input, set to "A".

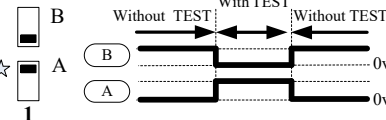

EN16005 Set to "B" to comply with EN16005

2/ Optical Interference

To avoid cross interference between two sensors in close proximity different frequency settings should be selected

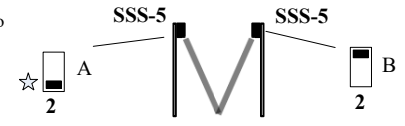

3/ Relay Output Mode



4/ Masking Detection Spots

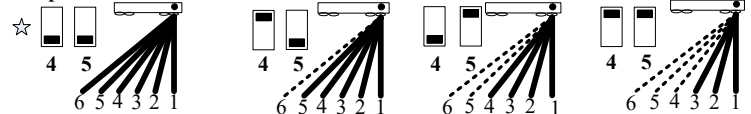

5/ Setting Non-Detection Distance

Set Non-Detection distance (A)

EN16005 Check that the detection range conforms to EN16005

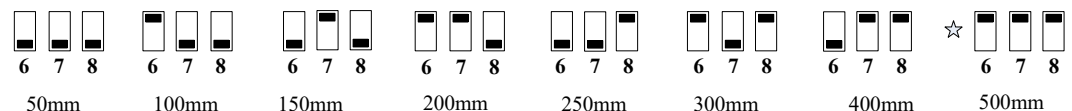
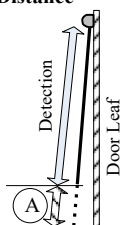

4. DETECTION ANGLE ADJUSTMENT

The detection angle can be adjusted between 5 - 25 [deg] in 5 [deg] increments using the Angle Stabilizer.

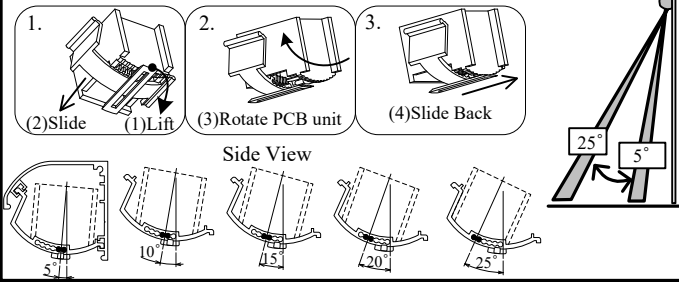

6. TEACHING

TEACHING is necessary so that the sensor can learn the distance from the sensor to the floor.

- 1/ Clear the detection area
- 2/ Press the "Push SW" switch for 2s or more
- 3/ GREEN & RED LED flashes slowly for 10s, followed by faster frequency flashes indicating that TEACHING is been executed (If during this time, a person or object is in the detection area, try again from STEP 1.)
- 4/ Green LED flashes once to indicate that the TEACHING process is complete
- 5/ Verify the detection area for conformity to local regulations

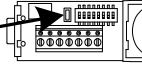

8. FINAL DETECTION RANGE CHECK

After the Filter Cover is fitted, confirm that the detection range is as expected and conforms with local regulations.

EN16005 Check that the detection area conforms to EN16005

5. LED

Standby:	GREEN LED ON
Detecting:	RED LED ON
Environmental Error:	Fast alternate RED/GREEN LED followed by 1 flash of RED LED. If this happens execute the TEACH function again with a white sheet of paper on the ground.
Internal Sensor Failure:	Fast alternate RED/GREEN LED followed by 3 flashes of the RED LED

7. REPLACE FILTER COVER

Install the Filter Cover

- 1/ First fit the upper side of the Filter Cover into the full length of the Aluminum Case.
- 2/ Slightly bend the Filter Cover at one end to latch it onto the bottom lip of the Aluminum Case.
- 3/ Slide your hand along the bottom lip to lock the Filter Cover in place

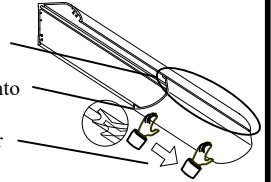

Attach the Joint

- 1 Snap the Joint into Aluminum Case.
- 2 Slide the Joint so that it fits snugly into the Filter Cover.
- 3 Attach remaining Filter Cover as illustrated

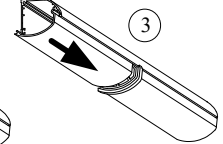
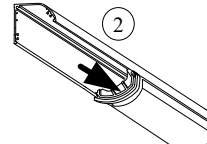
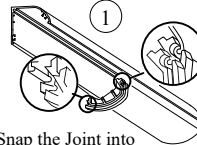

Cut out the Side Cover wiring point and insert the Wire Sheath into it.

Attach the Side Cover with Screws provided.

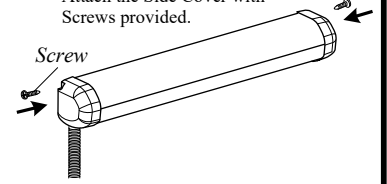
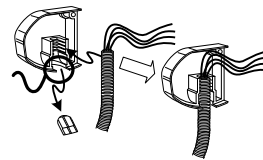

For a more detailed explanation on how to install the SSS-5 sensor please see the full installation instructions on our website at: https://hotron.com/wp-content/uploads/2020/09/mp-10193_04_d201911271.pdf